

METROLINK Matters

Metrolink News and Events

June 2007



Introducing the New and Improved Metrolinktrains.com

Metrolink is proud to introduce the all-new Metrolinktrains.com, the official Web site of Metrolink. Metrolinktrains.com sports a completely new look and feel, with new content and images and a fresh design that makes the site more user-friendly.

The new Web site features a *Station Locator* and an *Interactive System Map*. A *Featured Items* section on the home page highlights new features or current events, while a *scrolling headline* provides users fast access to important news and commuter updates.

Many other functions of the old Web site are now more easily navigable through the use of quick-links that offer visitors shortcuts to frequently used areas of the Web site. The new look is designed to make it easier for visitors to find the information they need about Metrolink's services and programs.

We hope you'll take a look at www.metrolinktrains.com.

Did You Know?

You can now see a daily summary of prior-day Metrolink train operations on the new Metrolinktrains.com. This new feature, located under the *News Updates* section of the home page, will list trains that were delayed 15 minutes or more on the previous day (weekdays only), and will indicate the primary reason for the delay.

(continued on page 4)

Fare Increase

On May 11, Metrolink's Board of Directors approved a three-year program of fare increases under which the system-wide average fare will increase by 3.5 percent each year, effective July 1, 2007; July 1, 2008; and July 1, 2009. Metrolink fares are also transitioning from a zone-based system to a calculation based on the equivalent driving distance between stations. We realize that nobody wants to pay more for any goods and services, especially in an environment with rising fuel and grocery prices. Still, even though the cost to operate Metrolink trains increases every year Metrolink fares have actually increased less than the average Consumer Price Index for our region has since 2002. Metrolink appreciates all of the comments received from passengers about the proposed fare increase as

well as input about the operation of our trains. While many of those comments have been addressed in an expanded FAQ section on the metrolinktrains.com website, future issues of *Metrolink Matters* will also be featuring a look at some of them in greater detail. We plan to provide more information about how trains are scheduled, what goes into decisions about when to operate more trains on a particular route and what some of the realities are of operating trains on routes that are owned by another railroad.

Metrolink thanks all of our passengers for riding and doing their part to reduce traffic congestion and improving our environment.

INSIDE

- 2 Construction Advisory: Industry Station
- 2 Kodak Theatre Tours
- 3 Safety Matters
- 4 City News



Construction Advisory: Industry Station

Beginning this summer, Industry Station commuters will need to use a new, temporary platform. The temporary platform has been created to accommodate the construction of a new railroad bridge and roadway underpass at Brea Canyon Road.

The Alameda Corridor East Construction Authority is building the new railroad bridge and roadway underpass in an effort to eliminate crossing congestion and

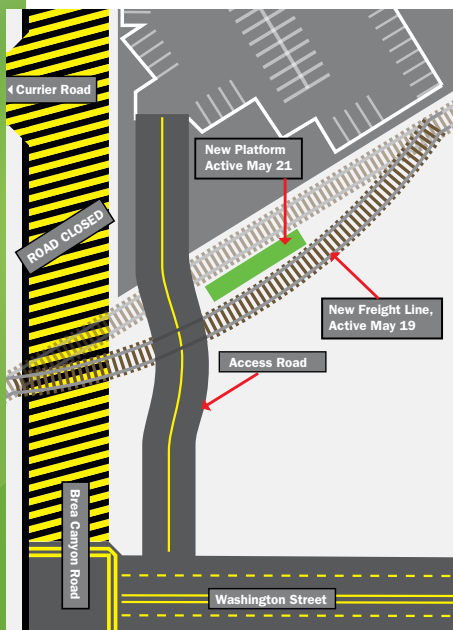

enhance safety. To allow workers to build the bridge on the existing track alignment, a temporary “shoofly” detour track has been constructed south of the existing tracks. For approximately one year, while trains travel on the “shoofly” tracks, commuters will use a temporary platform area located just north of the temporary tracks. The temporary platform will be accessible from the parking lot.

As always, please exercise caution around train tracks and crossings. Thank you for your patience and cooperation.

For additional information, contact the Alameda Corridor East Construction Authority at (888) ACE-1426 or visit www.theaceproject.org.

A Rail Romance

When Rita Salazar-Ryno and her kids took a Metrolink train to Union Station to enjoy Cinco de Mayo festivities at Olvera Street last month, the memories came flooding back. Eight years ago, Rita met her future husband, Kenneth, while they both waited for a Metrolink train. They were standing on the platform at Union Station, waiting for the last San Bernardino Line train. “He was in his officer’s uniform,” she remembers. “Blue eyes, six feet tall. Our eyes met, and that was it.”

Yet months would pass before their first date. “We talked on the train ride for months on end before he had the nerve to ask me for dinner,” she laughs. “We’d meet up on the ramp and talk all the way home.” They eventually married, and they’ve enjoyed numerous train-related vacations as a couple, always nostalgic about those early Metrolink rides together.

Salazar-Ryno notes that Metrolink has positively affected not only her personal life but also her professional life. In addition to years of fun, convenient commutes, Metrolink allowed her to build relationships with other riders she may never have known otherwise. One of her “train buddies” encouraged her to submit an application to the company where she worked, which led to Salazar-Ryno’s landing a job at one of the largest real-estate companies in Southern California.

Due to a change in office location, Salazar-Ryno is no longer able to commute via Metrolink—but she misses it, and she’s thrilled that the expanded weekend service allows her to ride the rails with her children to activities throughout Southern California.

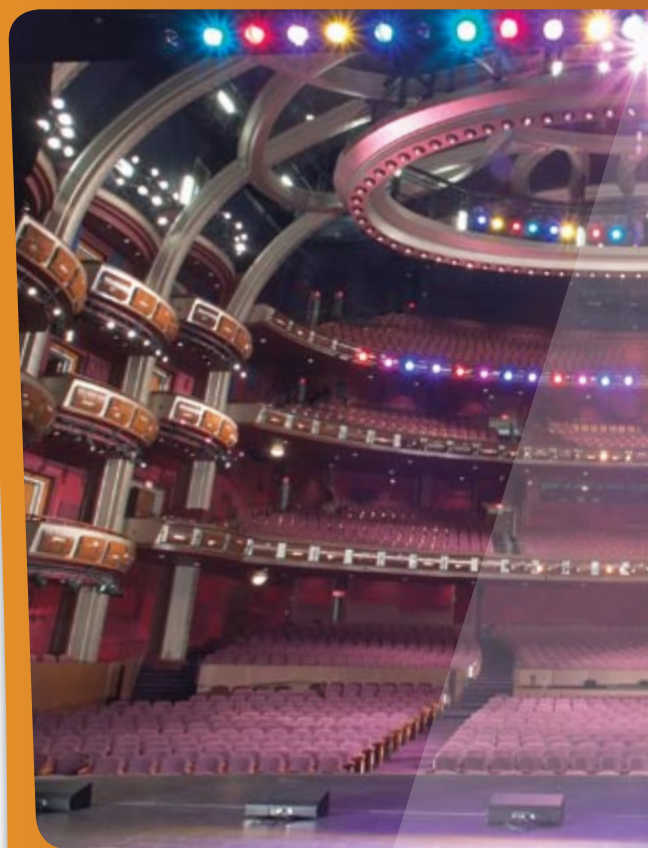

Kodak Theatre Tours

It’s your turn to step beyond the red carpet!

The Kodak Theatre in Hollywood is now offering guided tours. Experience all of the renowned elegance and glamour that the home of the Academy Awards® ceremonies has to offer. See an Oscar® statuette, learn where your favorite celebrities sit, visit the exclusive George Eastman VIP Room, and get an insider’s view of many other popular events like the *American Idol* finals, ESPY Awards, AFI Awards, Daytime Emmy Awards, and much more.

Tours run daily from 10:30 a.m. to 4:00 p.m., subject to theater availability.

Bring your valid Metrolink ticket or pass to the Kodak Theatre box office (located on Level 1 of the Hollywood & Highland Center) and get adult admission for the youth admission price*—only \$10* per person all summer long (June to August)—along with a free Elephant Card good for special discounts at retailers and restaurants throughout the Hollywood & Highland Center.

Remember, your Metrolink ticket or pass is good for a free transfer on the Metro Red Line to the Hollywood/Highland Metro Station.

The Kodak Theatre is conveniently located at the Hollywood/Highland Metro Red Line station.

To find out more, visit www.kodaktheatre.com.



* Cannot be combined with any other offers or discounts. One \$10/person admission price per valid Metrolink ticket or pass. Restrictions apply. Offer valid through 8/31/07.



Exercising for Safety

Union Station literally "went to the dogs" on Saturday, April 28, as Transportation Security Administration (TSA) strike teams attempted to infiltrate Union Station while using public transit. Keys to the exercise were twenty-one explosive-sniffing dogs and their handlers.

More than 200 law-enforcement personnel with the Los Angeles County Sheriff's Department (including Metrolink Division dogs and handlers), the Orange County Sheriff's Department, the Los Angeles Police Department, the Amtrak Police, the U.S. Department of Homeland Security, and K-9 units tested security on several trains arriving at Union Station that day. Metrolink trains were stopped at Glendale, Cal State L.A., and Norwalk.

The K-9 units inspected passenger bags. (Passengers were free to opt out of the voluntary exercise.) Ed Pederson, Manager of Safety and Security for Metrolink, stated that about 50 percent of passengers participated on southbound and westbound trains, and about 90 percent participated on northbound trains.

The TSA strike teams were all carrying mock explosive devices. All five mock devices were discovered before they reached their targets.



SAFETY MATTERS

Metrolink and the Southern California Rail Safety Team have been working with law-enforcement agencies around Southern California to promote safe behavior around railroad crossings and on railroad property. On March 7, 2007, Metrolink, Amtrak, BNSF Railway, Union Pacific Railroad, the California Public Utilities Commission, and the Fullerton Police Department coordinated the first countywide enforcement event with police departments throughout Orange County. Eighty-five police officers participated by monitoring vehicle and pedestrian activity at several Orange County railroad crossings. They issued citations to both drivers and pedestrians for violations such as trespassing on or near railroad tracks, failing to stop at a railroad crossing signal, and driving around lowered railroad crossing gates. During the six-hour event, 209 citations were issued to drivers and twenty-two citations were issued for trespassing. Five arrests were made, two stolen vehicles were recovered, and seventeen vehicles were impounded.

On Wednesday, April 7, 2007, the Pacific Harbor Line railroad joined forces with the Southern California Rail Safety Team and several law-enforcement agencies during an Officer-on-the-Train safety event in San Pedro. Officers from the L.A. County Sheriff's Department, the Metrolink Sheriff's Transit Bureau, the BNSF Railway Police, the Union Pacific Police, the Los Angeles Police Department, the California Highway Patrol, and the Port Police observed several railroad crossings in the Wilmington/San Pedro area. During the five-hour operation, ninety-five vehicle citations were written; five drivers received warnings; nine vehicles were towed; and seven pedestrian trespassing citations were issued.

For more information about Metrolink's safety programs, visit metrolinktrains.com or call (800) 371-LINK (5465).



City News

Downtown Burbank— Make it a day of great art, music & food at the San Fernando Valley's biggest arts festival, Saturday and Sunday, June 9 and 10 from 10:00 A.M. to 5:00 P.M. on San Fernando Boulevard between Magnolia and Angeleno in Downtown Burbank. Meet more than 100 award-winning artists selling original works, demonstrating their craft and discussing the creative process, both days. Attendees can purchase or commission unique works of art at affordable prices, enjoy live musical entertainment, watch pottery wheel demonstrations and see chalk artists recreate masterpieces on city streets.

Pomona—On June 7, 2007, the Pomona Central Business District and the Downtown Pomona Owners' Association will commence Fresh Air Flicks, a month-long series of free weekly, outdoor movie screenings

in Metro Pomona's Thomas Plaza. Every Thursday night in June, a movie will begin at 8:30 p.m. Fresh popcorn, hot dogs, and other treats will be available for purchase. Filmgoers are encouraged to B.Y.O.C. (bring your own chair).

2007 Fresh Air Flicks Schedule

June 7	<i>Raiders of The Lost Ark</i> (PG)
June 14	<i>The Shining</i> (R)
June 21	<i>The Karate Kid</i> (PG)
June 28	<i>The Jerk</i> (R) and <i>Fast Times at Ridgemont High</i> (R)

For more information about Fresh Air Flicks, please visit www.metropomona.com or contact Emily Markowitz, executive director of the Downtown Pomona Owners' Association, at (909) 261-5004.



The Greatest Show on EarthSM

Ringling Bros. and Barnum & Bailey® present the all-new, 137th edition of their circus with BellobrationSM, starring the amazing comic daredevil Bello and his friends. The circus will be visiting Staples Center and the Honda Center in July and August. You'll see gravity-defying acrobats, white Bengal tigers, extreme clowns, zebras, dancing horses and elephants performing handstands, and much, much more! Two Metrolink passengers will have a chance to win a VIP package to the Staples Center show on Sunday, July 22, at 7:30 p.m. The VIP package includes four VIP tickets, four programs, and one special gift, all valued at \$230.



For a chance to win a VIP package for four, simply fill out the entry form below and mail it by June 29, 2007, to *Metrolink Matters*, The Greatest Show on Earth, 700 S. Flower Street, Suite 2600, Los Angeles, CA 90017.

Name: _____

Address: _____

E-mail: _____

Daytime Phone Number: () _____

One entry per person. All winners will be contacted by phone.

Photo courtesy of Ringling Bros. and Barnum & Bailey®

Did You Know?...*(Continued from page 1)*

Only trains that have been delayed 15 minutes or more will be listed on the daily summary as "significantly delayed." Those trains delayed for fewer than 15 minutes will be considered to have "operated on schedule" for the posted daily summary. Information about trains operating Mondays through Thursdays will be posted the following day. Information about trains operating on Fridays will be posted the following Monday.

We hope our passengers will find this a valuable new resource.

Train Groupies

Metrolink Matters is still looking to feature groups of commuters who come together on a regular basis to play, work or just socialize.

Send us a short description of your group, a creative group name, photos, and contact information. If we spotlight your group, each member will win a free Metrolink shirt.

Send your entry via e-mail to metrolinkmatters@scrra.net, or via postal mail to *Metrolink Matters*, Train Groupies, 700 S. Flower Street, Suite 2600, Los Angeles, CA 90017. Entries can be submitted until July 2, 2007.

Name: _____
 Address: _____
 E-mail: _____
 Phone Number: () _____
 Train Group Name: _____
 Description: _____

METROLINK MATTERS

Editor-in-Chief: Paul Sitkoff
 Contributors: Charlene Ariza, Tracy Berge, Anja Magnani, and Francisco Oaxaca
 Designer: Harlan West/HWDS
 Writing Consultant: Jessica Hoffmann
 C.E.O.: David Solow
 Director, Communications and Development: Steve Lantz
 Manager, External Communications: Francisco Oaxaca

Send comments or story ideas to metrolinkmatters@scrra.net or to *Metrolink Matters*, 700 S. Flower St., Suite 2600, Los Angeles, CA 90017.

Published by the External Communications Department.

Printed on recycled paper with soy ink.

HWDS1539-5/07

